

HUNTER CREEK

ELEVATION 5920 FT

GATED COMMUNITY, UNDERGROUND UTILITIES, SEWER, PAVED ROADS, 100 YR. CERTIFIED WATER SUPPLY, HOA WATER CO, SITE BUILT ONLY, HOMEOWNERS ASSN, ELEVATION 5920 FT, ZONING - R1L-D18, CELL PHONE AND INTERNET SERVICE AVAILABLE, CHRISTOPHER KOHL'S FIRE DEPT www.hcr-hoa.com

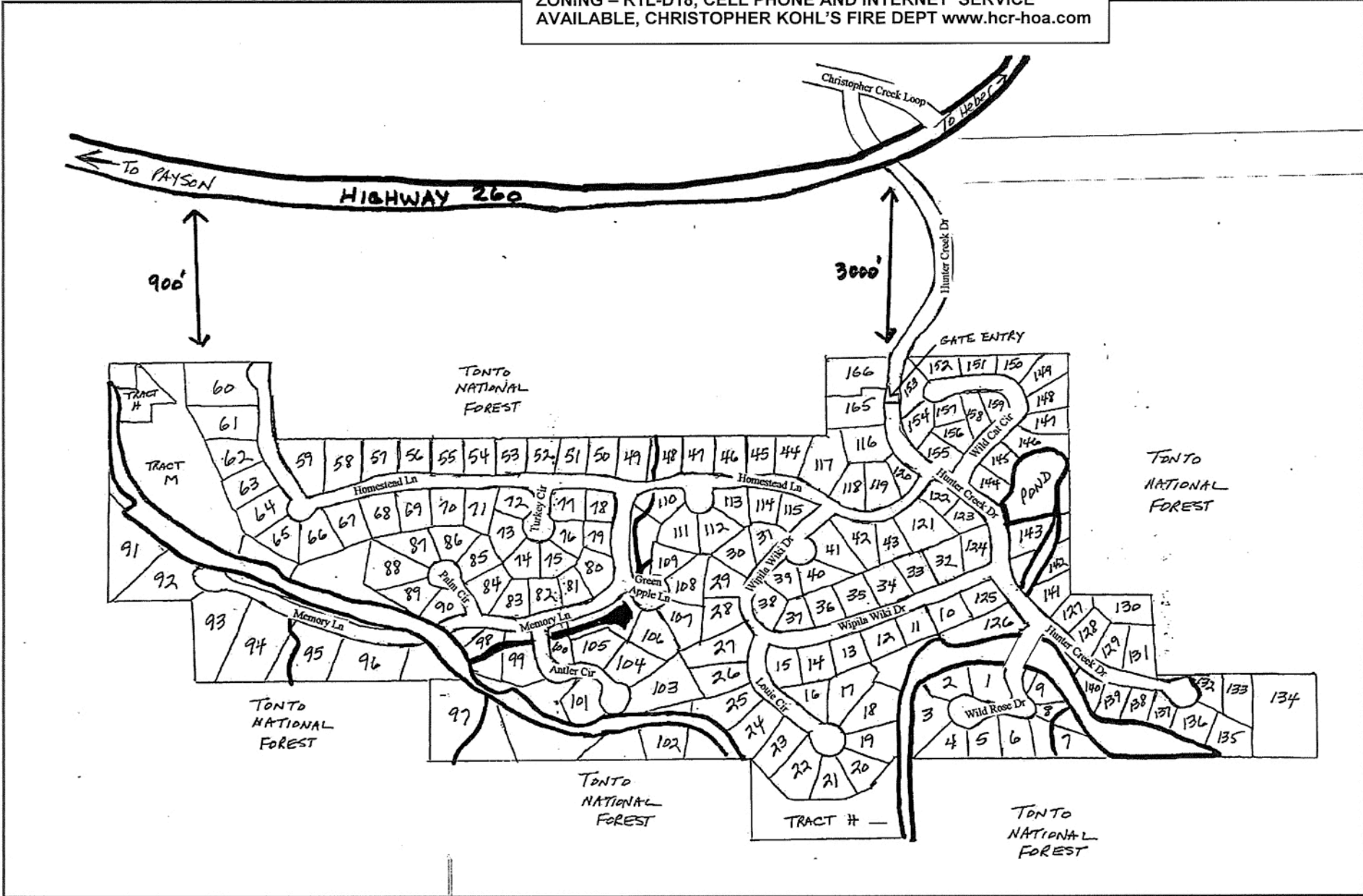

NOT A PLAT MAP
FOR LOCATION
PURPOSES ONLY